



## T-Star 220 Smart Gateway InferStack™ Platform



- 3G modem
- Ethernet LAN for BACnet™, Modbus®
- 5 or 15 points InferStack™
- Pass-through modem

## T-Star 220 Data Sheet

The T-Star 220 InferStack™ platform is used in two main ways, either for a small number of InferStack™ points for Energy Monitoring or similar applications or as a conventional, pass through modem to connect field devices on the Ethernet LAN to an enterprise server over cellular 3G.

The T-Star 220 is part of a comprehensive range of Hardware, Software and Connection Services that enable Service Providers to deliver the benefits of the Internet of Things to Intelligent Buildings, Equipment and Smart Devices.

InferStack™ provides elegant, simple to design Visualization of real-time and historical data with Graphics and Dashboards, the powerful B-Line Control Engine, custom Reporting, simple and effective Alarm and Event Handling.

InferStack™ incorporates the Project Haystack standard for Data Modeling.

A built in Wi-Fi Access Point allows Mobile Devices to Communicate with the T-Star 220 Platform for ease of set up and commissioning.

## Architecture

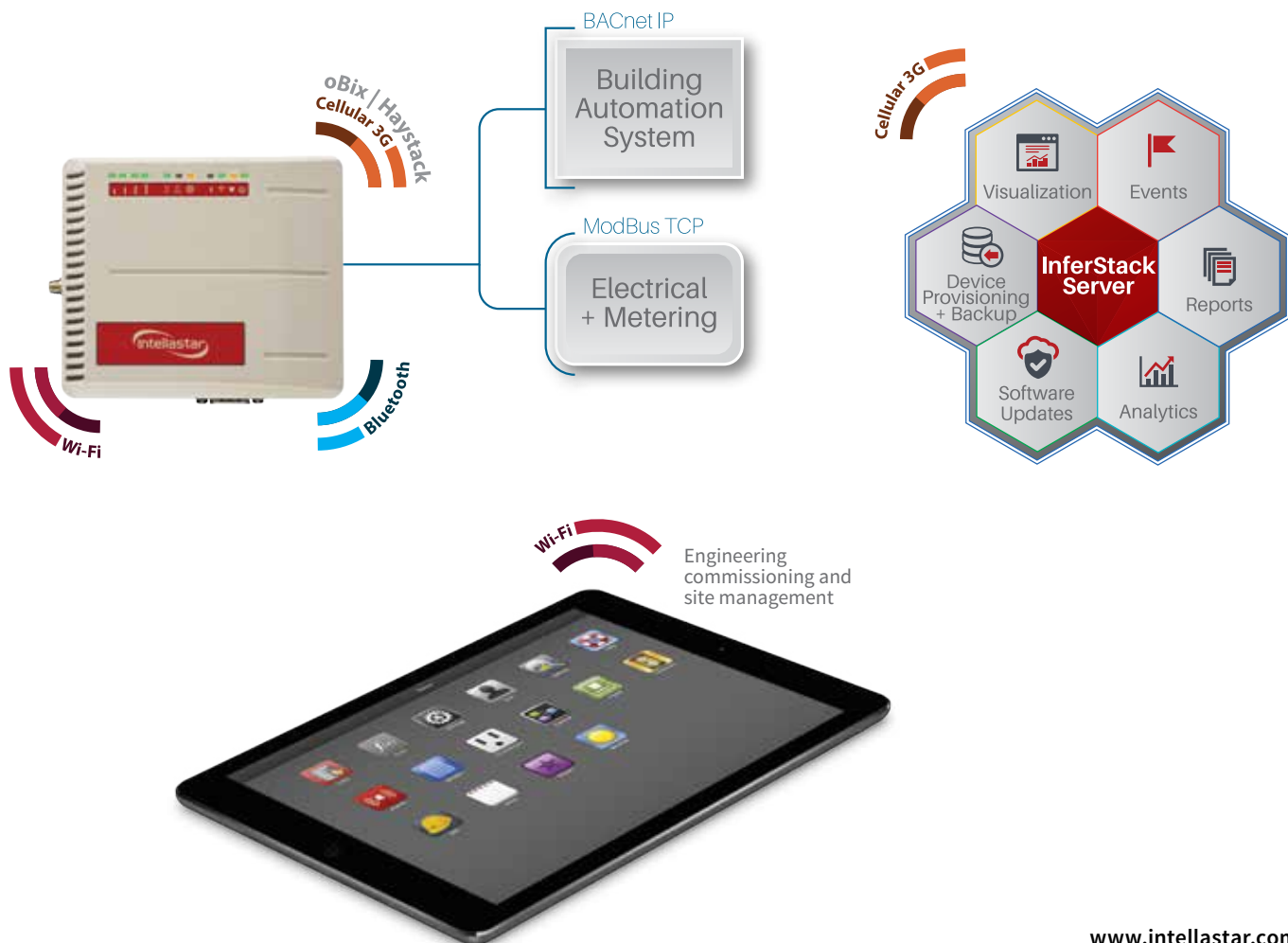

## Software

# InferStack™

- InferStack™ Application Environment with Project Haystack modeling.
- Wind River® Linux 5 Operating System with Java® Virtual Machine
- IP protocols Modbus® TCP, BACnet™ IP, oBIX™, Haystack™

## Mounting Dimensions

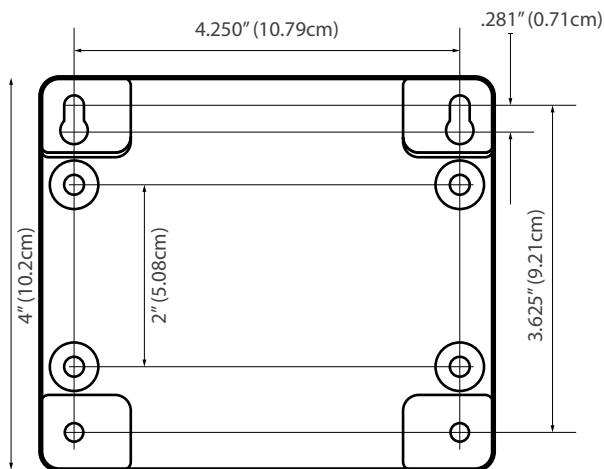

- Molded plastic case, convection cooled
- Multiple mounting options—desk, wall, or in enclosure
- Net weight 1.0 pound (0.45 Kg)

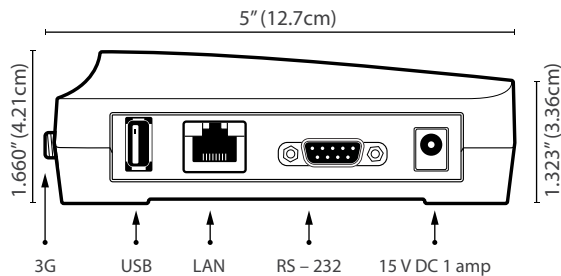

## Hardware

- TI ARM Cortex™ A8 Cortex processor @ 600 MHz
- 256 MB DDR3 RAM
- 8 GB Micro SD Flash for system and application data backup
- Trusted Platform Module (TPM) for security
- 1 10/100 MBit Ethernet port
- Wi-Fi for data and user interface connectivity
- Bluetooth v4.0 BLE
- 1 RS-232 port: DB9 male connector
- Optional on board 3G modem, CDMA or GSM
- Power—15 volts DC
- Rechargeable internal battery backup
- Multiple Mounting Options—Desk, Wall or Enclosure
- Environmental Operating range  
0 to 50 Degrees C (32 to 122 Deg. F)  
Humidity 0 to 90% RH non-condensing

## Agency Listings

- UL-60950 or Met Labs equivalent
- FCC Part 15 Class B for electromagnetic and Class C for modem
- RoHS compliant
- CE compliant

## Ordering Information

Part Number	Description
220C	InferStack™ w/ 5 pts & CDMA modem
220G	InferStack™ w/ 5 pts & GSM modem
220-10P	InferStack™ 10 point expansion pack

15 points is the maximum number of points for the 220 embedded platform.