



# T-Star 225 Wireless Mesh InferStack™ Platform



- 3G Modem option
- Ethernet LAN for BACnet™, Modbus®
- 802.15.4 Wireless with JenNet IP™

## T-Star 225 Data Sheet

The T-Star 225 InferStack™ Platform is primarily aimed at 802.15.4 JenNet-IP™ Wireless applications and will communicate with WAM modules or other similar wireless devices. An Ethernet LAN supports BACnet™ IP and Modbus® TCP and is used to connect to Building Automation Systems, electrical and metering systems and similar. 3G modem, GSM or CDMA optional to connect T-Star 225 to InferStack™ enterprise server.

The T-Star 225 InferStack™ Platform is part of a comprehensive range of Hardware, Software and Connection Services that enable Service Providers to deliver the benefits of the Internet of Things to Intelligent Buildings, Equipment and Smart Devices.

InferStack™ provides elegant, simple to design Visualization of real-time and historical data with Graphics and Dashboards, the powerful B-Line Control Engine, custom Reporting, simple and effective Alarm and Event Handling and optional industry leading on-board Analytics.

The Platform is used for many Applications including:

- Energy Monitoring and Analysis
- Building and Plant Fault Detection and Diagnosis
- Plant Control and Optimization
- Smart Grid and Automatic Demand Response

InferStack™ incorporates the Project Haystack standard for Data Modeling.

A built in Wi-Fi Access Point allows Mobile Devices to Communicate with the T-Star 225 Platform for ease of set up commissioning and all visualization.

## Architecture



## Software

# InferStack™

- InferStack™ Application Environment with Project Haystack modeling.
- Wind River® Linux 5 Operating System with Java® Virtual Machine
- IP protocols Modbus® TCP, BACnet™ IP, oBIX™, Haystack™
- JenNet IP on 802.15.4 Wireless

## Mounting Dimensions

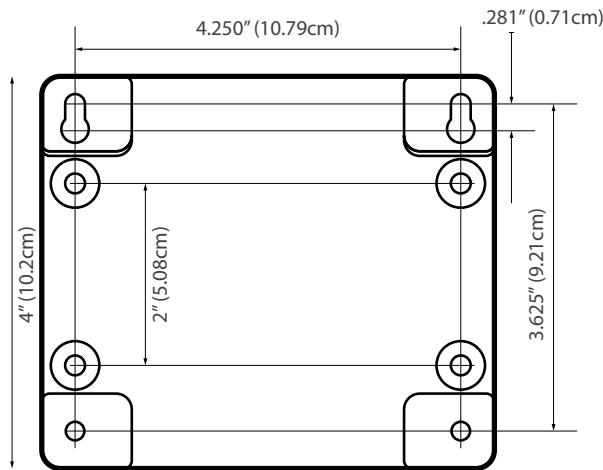

- Molded plastic case, convection cooled
- Multiple mounting options—desk, wall, or in enclosure
- Net weight 1.0 pound (0.45 Kg)

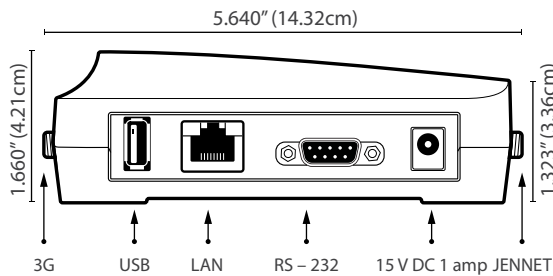

## Hardware

- TI ARM Cortex™ A8 Cortex processor @ 600 MHz
- 512 MB DDR3 RAM
- 8 GB Micro SD Flash for system and application data backup
- Trusted Platform Module (TPM) for security
- 1 10/100 MBit Ethernet port
- Wi-Fi for user interface connectivity
- Bluetooth V4.0 BLE
- 1 RS-232 port: DB9 male connector
- Optional 3G modem, CDMA or GSM
- Power—15 volts DC
- Rechargeable internal battery backup
- Multiple Mounting Options—Desk, Wall or Enclosure
- Environmental—Operating range  
0 to 50 Degrees C (32 to 122 Deg. F)  
Humidity 0 to 90% RH non-condensing

## Agency Listings

- UL-60950 or Met Labs equivalent
- FCC Part 15 Class B for electromagnetic and Class C for modem
- RoHS compliant
- CE compliant

## Ordering Information

Part Number	Description
225N	InferStack™ w/ 30 pts & no 3G modem
225C	InferStack™ w/ 30 pts & CDMA modem
225G	InferStack™ w/30 pts & GSM modem
225-100P	InferStack™ 100 pts expansion pack
225-200P	InferStack™ 200 pts expansion pack
225-30A	InferStack™ Analytics 30 pts pack
225-100A	InferStack™ Analytics 100 pts pack
225-200A	InferStack™ Analytics 200 pts pack

The maximum number of InferStack™ points a 225 will accommodate is 430 embedded platform points & 430 analytics points.

InferStack™ Analytics is an option. If used, the number if analytics points must be the same as platform points.